

# N600

## SPRING REWIND DUAL HOSE REELS

To handle dual 1/4" through 1/2" I.D. hose.

- Narrow frame and compact mounting base.
- Non sparking ratchet assembly.
- Declutching arbor to prevent damage from reverse winding.
- Standard inlets 90° balanced pressure swivel joints 1/2" female NPT threads.
- Standard outlets 1/2" female NPT threads.
- Pressures to 3000 psi (207 bar)
- Temperatures from -60° F to +250° F (-51°C to +121°C).
- Consult factory for other pressures & temps.
- 4-way roller assembly.
- Constant Tension is available – consult factory.
- Reels for use with oxygen/acetylene.  
See Series N400 Hannay Reels Welding Catalog H-0408-W.

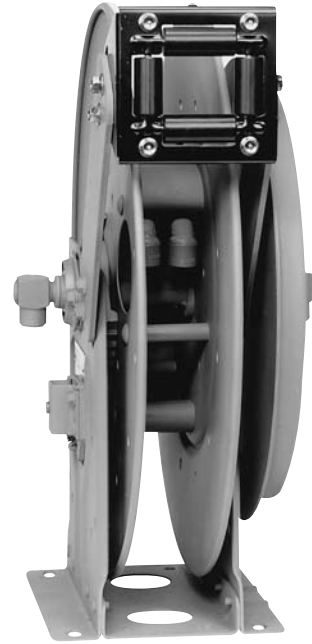

Optional TR roller position shown

For:

- Hydraulics
- Air/Water
- Paint Spraying

Model Number	Hose Capacity of Reel feet m.				Approx. Weight lb. kg.		Standard Roller Assy	Reel Dimensions*** inches mm.							
	I.D. (in) I.D. (mm)	1/4" 6	3/8" 10	1/2" 13	NET	SHIP		A	B	C	E	F	G	H	X
	O.D. (in) O.D. (mm)	5/8" 16	3/4" 19	7/8" 22											
N615-19-20C		2/35 2/11	2/35 2/11	2/20 2/6	63 28.6	78* 35.4	N203	9 229	3 76	10.5 267	20.75 527	11.75 298	20 508	10.62 270	7 178
N617-19-20J		2/50 2/15	2/50 2/15	2/25 2/8	66 29.9	86* 39	N205	11 279	5 127	10.5 267	20.75 527	13.75 349	20 508	10.62 270	9 229
N615-23-24B		2/65 2/20	2/60 2/18	2/30 2/9	87 39.5	104* 47.2	N203	9 229	3 76	10.5 267	23.75 603	11.75 298	24 610	12.62 321	7 178
N617-25-26-15.5B		2/75 2/23	2/75 2/23	2/50 2/15	93 42.2	128 58.1	N205	11 279	5 127	15.5 394	25.25 641	13.75 349	26 660	13.62 346	9 229
N617-25-26-15.5A		2/100 2/31	2/85 2/26	- -	120 54.4	155 70.3	N205	11 279	5 127	15.5 394	25.25 641	14.5 368	26 660	13.62 346	9 229

**Notes:**

1. Specifications subject to change.
2. Reel models and capacities shown are for standard drag applications; for vertical lift applications consult factory.
3. Other sizes, from standard components, available on request.
4. For a detailed parts breakdown drawing request ISO 80.
5. **Finish:** refer to Page 4.

**6. Be sure to check dimensions and weights prior to ordering.**

**NOTICE:** A Flexible Connector must be used between the inlet pipe and the inlet swivel joint.

\* When shipped as a parcel package (via Fed-Ex or UPS Ground).

\*\*\* x,y indicate mounting holes. See page 2



Available Roller Positions

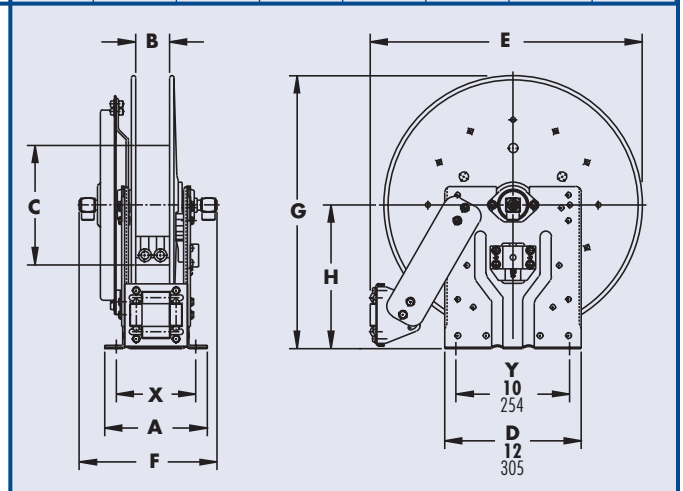

For hydraulic tool circuit applications full flow swivels w/viton seals are recommended (add 2.25 to "F" dim in chart)