

ETS Co., Inc., 20 E. Winona Ave. Norwood, PA 19074
 Telephone 610-583-7657 • Toll free 1-877-824-7763
 FAX 610-583-5479
 Website: [http:// www.etsHoseReels.com](http://www.etsHoseReels.com)
 E-mail: info@etshosereels.com

ISO 164

PARTS LIST

NSCR SERIES

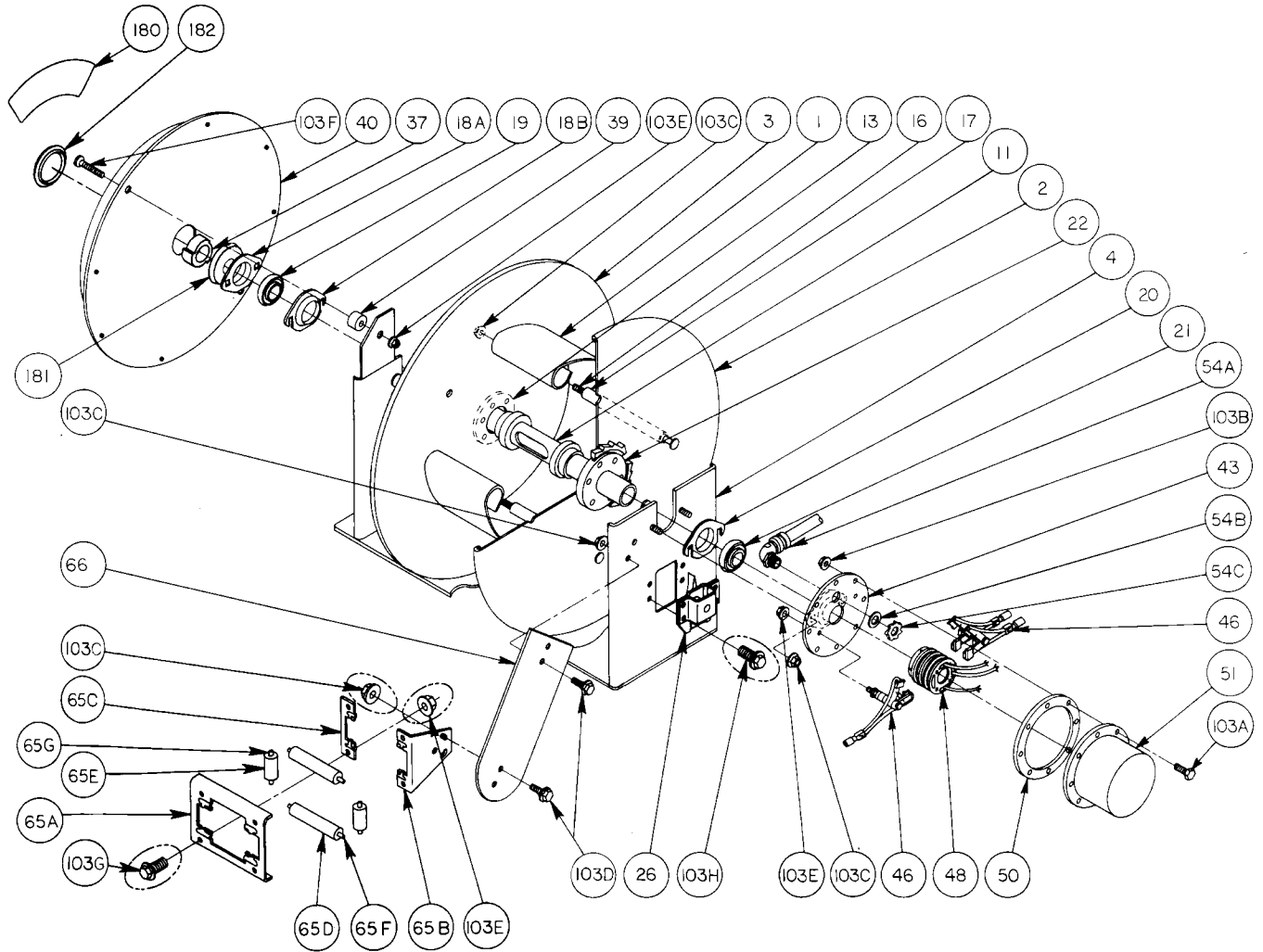

**PARTS LIST
ISO 164
NSCR SERIES**

When ordering parts

**BE SURE TO SPECIFY COMPLETE MODEL NUMBER and SERIAL NUMBER OF REEL.
USE PART NUMBER!**

<u>Drawing No.</u>	<u>Description</u>	<u>PART NUMBER</u>	<u>Quantity</u>
1	Drum, 10-1/2" Diameter(Specify Model)	9905.0138	1
	Drum, 15-1/2" Diameter(Specify Model)	9905.0178	1
2	Front Disc, 16-17.....	9903.0421	1
	Front Disc, 19-20.....	9903.0821	1
	Front Disc, 23-24.....	9903.1121	1
3	Back Disc, 16-17.....	9903.0421	1
	Back Disc, 19-20.....	9903.0821	1
	Back Disc, 23-24.....	9903.1121	1
4	Frame Assembly.....	Specify Model	1
11	Hub for NSCR.....	9955.0066	1
13	EH-936 Disc Washer.....	9965.0015	1
16	3/8" Carriage Bolt.....	Specify Model	6
17	3/8" Spacer Pipe.....	Specify Model	6
18A	Back S.A. Bearing Holder.....	9902.2800	1
18B	Back S.A. Bearing Holder - Slotted for "N" Series.....	9902.2801	1
19	1-1/2" S.A. Bearing Insert.....	9902.4001	1
20	Front S.A. Bearing Holder - Slotted for "N" Series.....	9902.2801	1
21	1-1/2" S.A. Bearing Insert.....	9902.4001	1
22	Ratchet Wheel.....	9922.0003	1
26	Ratchet Locking Assembly, GH-785.....	9951.0006	1
37	Spring Arbor.....	9922.0002	1
39	Spring Mounting Spacer, GH-467.....	9922.0033	1
40	"B" Spring.....	9921.0015	1
	"J" Spring.....	9921.0030	1
43	Collector Backing Plate w/S.A. Bearing Holder.....	9943.0070	1
46	Brush & Holder Assembly.....	9943.0019	3
48	3 Conductor Collector Ring.....	Specify Amperage	1
50	Rubber Gasket.....	9943.0004	1
51	Collector Cover (3 Cond).....	9943.0001	1
54A	Strain Relief, 90 Degree - Specify Gauge of Cable.....	9955.0009	1
54B	3/4" Reducing Washer for Strain Relief.....	9955.0013	2
54C	3/4" Locking Nut for Strain Relief.....	9955.0014	1
65A	Roller Bracket Frame, GH-895.....	Specify Model	1
65B	Narrow Series Roller Mounting Bracket, GH-897.....	9940.0171	1
65C	Narrow Series Roller End Cap, GH-898.....	9940.0172	1
65D	1" Dia. Roller For Stamped Housing, GH-1012.....	Specify Model	2
65E	1" Dia. Roller For Stamped Housing, 2" Long, GH-1012A.....	9940.0180	2
65F	1/4" Dia. Stainless Steel Rod.....	Specify Model	2
65G	1/4" Dia. Stainless Steel Rod, 2-3/4" Long.....	9940.0190	2
66	Roller Mounting Arm, 16-17 Disc.....(Specify Model)	9941.0030	1
66	Roller Mounting Arm, 19-20 Disc.....(Specify Model)	9941.0031	1
66	Roller Mounting Arm, 23-24 Disc.....(Specify Model)	9941.0032	1
103A	1/4"-20 x 3/4" Hex Head Cap Screw.....	9904.1001	8
103B	1/4"-20 Spinlock Nut.....	9904.6000	8
103C	3/8"-16 Spinlock Nut.....	9904.6200	14
103D	3/8"-16 x 3/4" Spinlock Bolt.....	9904.2201	4
103E	5/16"-18 Spinlock Nut.....	9904.6100	4
103F	5/16"-18 x 1-1/4" Hex Socket Button Cap Screw.....	9904.9103	2
103G	5/16"-18 x 3/4" Spinlock Bolt.....	9904.2101	4
103H	5/16"-18 x 3/4" Thread Cutting Screw.....	9958.0055	4
180	Caution Decal, "Spring Under Tension".....	9922.0010	1
181	Cap-Plug for Spring (Inner Side).....	9922.0036	1
182	Cap-Plug for Spring (Outer Side).....	9922.0037	1