

Audio/Video Reels

HANNAY REELS



 **Hannay[®]
Reels**
The reel leader.

For use in:

- Production & Recording Facilities
- Television & Radio Stations
- Live Events & Concerts
- Mobile Broadcast Units
- Satellite & Cable Companies

H-9703-A/V
Rev. 3

Audio/Video Reels For fast rollout and storage.

Hannay AV series reels are specifically designed for broadcast and pro-audio applications. The reels are stackable for maximum transport and storage efficiency. Side mounted connector panels accommodate almost any combination of XLR and BNC connectors. Rugged steel construction and adjustable friction brake assure continuous smooth operation and prevent cable damage. Model AV-2 features optional heavy-duty casters for convenient transport on-site.

AV Series Reels

- Rugged steel construction throughout, including square tubing frame
- Black, non-reflective matte finish
- Removable side panel allows complete customization of XLR and/or BNC connector patterns (blank panel is supplied as standard)
- Standard strain relief inside panel compartment prevents damage to cable
- Channels allow stackability of reels for maximum storage efficiency
- Ergonomic carrying handles allow one or two person transport
- Adjustable friction brake to prevent cable overrun during operations
- Optional heavy-duty, locking caster wheels (set includes 2 locking and 2 non-locking casters) available on AV-2 reel



AV-1 standard configuration shown



(shown with optional casters)

AV-2 standard configuration shown

Dimensions

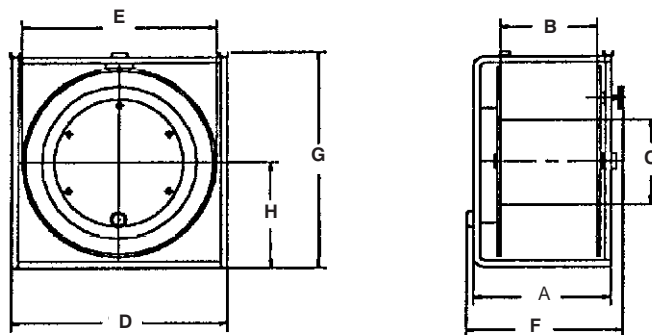

AV-1 and AV-2

Dimensions & Specifications

Series AV/AVX

AVX-100 Storage Reel

- Rugged steel and aluminum construction
- Black, non-reflective matte finish
- Durable tray provided for storage of stage box units
- Slotted divider disc design allows connector pigtails to be safely stored alongside snake cable
- Ergonomic carrying handle allows one or two person transport
- Adjustable friction brake to prevent cable overrun during operations

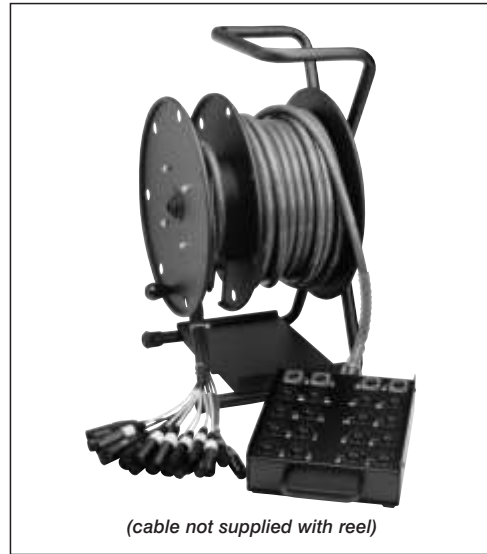

AVX-100 standard configuration shown

Dimensions

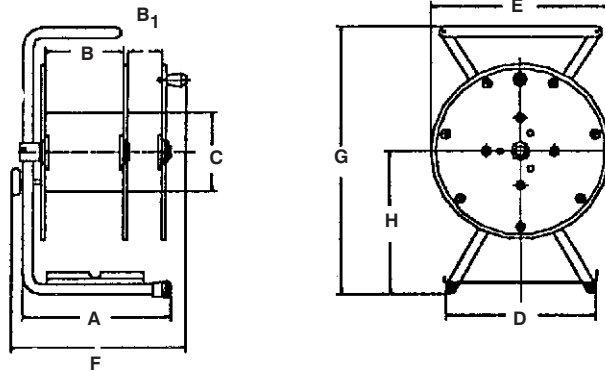

AVX-100

BE SURE TO CHECK DIMENSIONS AND WEIGHTS PRIOR TO ORDERING.

To receive a detailed parts breakdown drawing for AV-1 request ISO 190, for AV-2 request ISO 191, for AVX-100 request ISO 199.

Cable Capacity of Reels								Model Number	Reel Dimensions									Approx. Weight without cable	
feet m.									Inches mm.									Net	Ship
O.D. (in)	.245	.375	.41	.45	.49	.58	.67	A	B	B1	C	D	E	F	G	H			
O.D. (mm)	6	10	10	11	12	15	17												
	600	225	200	150	125	•	•	10.5	7	•	6	13.75	11.75	14.25	14.25	7	14	22	
	183	69	61	46	38	•	•	267	178	•	152	349	298	362	362	178	6	10	
	•	•	750	600	500	350	250	13	9	•	8	20	18	16.25	20.5	10	24.5	34	
	•	•	229	183	152	107	76	330	229	•	203	508	457	413	521	254	11	15.5	
	•	•	•	275	225	150	100	11	6	3	6	12	14	13.5	21	11.25	16	22	
	•	•	•	84	69	46	30	279	152	76	152	305	356	343	533	286	7	10	

Specifications Subject To Change

Portable Cable Storage Reels For broadcast applications.

AVC16-10-11

Model AVC16-10-11 portable cable reel is small, lightweight, and durable. Designed for quick and easy use, this reel is ideal for applications where long lengths of cable are payed out over large areas. Rewind is accomplished with a crank handle permanently attached to the disc. This model is equipped with our exclusive Cam-Lock drag/brake system to control spool speed. Also equipped with Velcro cable fastener to keep cable end secure. Coated in a non-reflective black matte finish.



AVC16-10-11 standard configuration shown

AVC20-14-16

Model AVC20-14-16 is a strong, portable reel for storing higher capacities of cable. Sturdy steel construction with direct crank rewind provides fast, easy pick-up. Perfect for applications with long cable runs or large diameter cable. Adjustable friction brake is standard. An optional spring drag device for braking is available. Coated in a non-reflective black matte finish.



AVC20-14-16 standard configuration shown

AVC1500 SERIES

Model AVC-1500 offers standard direct crank rewind permanently attached to the axle. Standard on manual rewind models, are a spring actuated pin lock and our Cam-Lock drag/brake. Coated in a non-reflective black matte finish.

Other AVC 1500 **Options:**

- Heavy Duty locking caster wheel set, includes 2 locking and 2 non-locking casters with mounting plates.
- Frame mounted carry handles.
- Divider Discs, (refer to picture on page 5)
Available with a cut-out for a separate “snake” lead storage. (Note: this disc location must be specified).



AVC-1500 standard configuration shown

Dimensions & Specifications

Series AVC

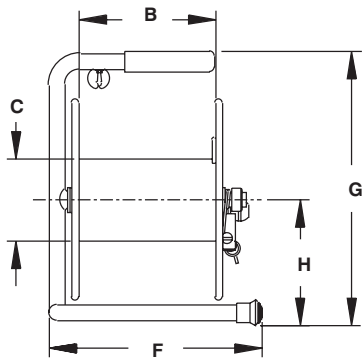

AVC16-10-11

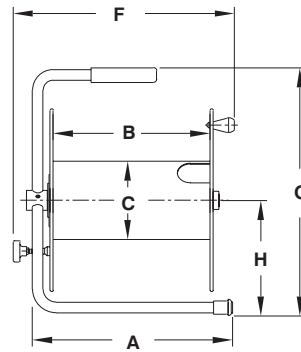
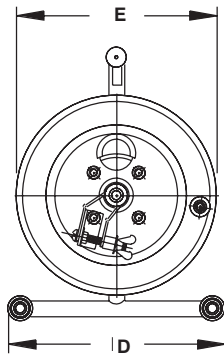

AVC20-14-16

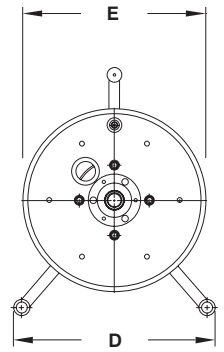

AVC-1500
(Shown with optional divider disc and larger disc diameters for added capacity)

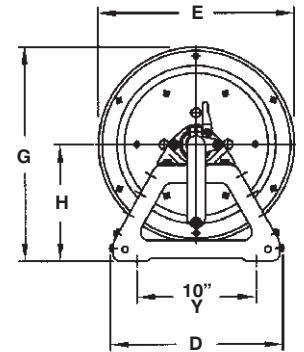
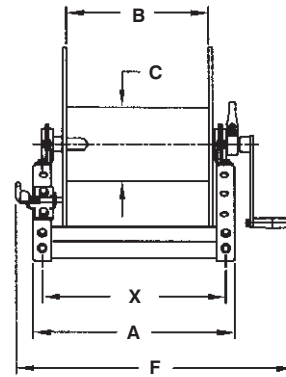

AVC1500 Series

BE SURE TO CHECK DIMENSIONS AND WEIGHTS PRIOR TO ORDERING.

To receive a detailed parts breakdown drawing for AVC16-10-11 request ISO 88, for AVC20-14-16 request ISO 121, for AVC1500 Series request ISO 90.

Cable Capacity of Reels		Model Number	Reel Dimensions								Approx. Weight without cable		
feet m.			Inches mm.								Lb. Kg.		
O.D. (in)	.245 .375 .41 .45 .49 .58 .67		A	B	C	D	E	F	G	H	X	Net	Ship
O.D. (mm)	6 10 10 11 12 15 17												
	600 225 200 150 125 • •	AVC16-10-11	•	7.5	4.5	11.88	10.75	11.75	15	6.88	•	10	13
	183 69 61 46 38 • •		•	191	114	302	273	298	381	175	•	5	6
	950 350 300 250 225 125 100	AVC16-14-16	11	7.5	6	15.5	14	12.75	19	8.62	•	17	25
	290 107 91 76 69 58 30		279	191	152	394	356	324	483	219	•	8	11
	• 550 400 350 300 200 125	AVC20-14-16	15	12	6	15.5	14	16.75	19	8.62	•	12	24
	• 168 122 107 91 61 38		381	305	152	394	356	425	483	219	•	5	11
	• 700 525 425 375 250 175	AVC1514-17-18	11	6	6	14.5	16.5	16	18.12	9.88	9.5	23	30
	• 213 160 130 114 76 53		279	152	152	368	419	406	460	251	241	10	13.5
	• • 800 700 575 425 250	AVC1516-17-18	13	8	6	14.5	16.5	18	18.12	9.88	11.5	24	31
	• • 244 213 175 130 76		330	203	152	368	419	457	460	251	292	11	14
	• • 800 700 575 425 250	AVC1520-17-18	17	12	6	14.5	16.5	22	18.12	9.88	15.5	25	32
	• • 244 213 175 130 76		432	305	152	368	419	559	460	251	394	11	14.5

Specifications Subject To Change

Portable Storage Reels on Wheels

Models AVC 1150 and AVATC 1250

These direct crank rewind reels are equipped with one-piece foot, rubber tires, and removable steel handlebar for long-term storage and shipping.

Finish: a non-reflective black air dried enamel.

Model AVC 1150 – For storing cable, or rope. A 7/8" x 1 3/4" (22.2 mm x 44.4 mm) opening in the drum permits the cable end to be inserted to initiate winding. This model supplied with a cam lock brake. This model offers an optional folding handle for compact storage.

Model AVATC 1250 – A larger version of the AVC 1150 model with pneumatic tires and a 4" x 5 1/2" (101.6 mm x 139.7 mm) drum opening. This model supplied with a spring tension brake.



Model AVC 1150
(shown with optional folding handle)

Model AVATC 1250

NOTE: THESE STORAGE REELS HAVE NO LIVE CONNECTIONS.

Dimensions and capacities

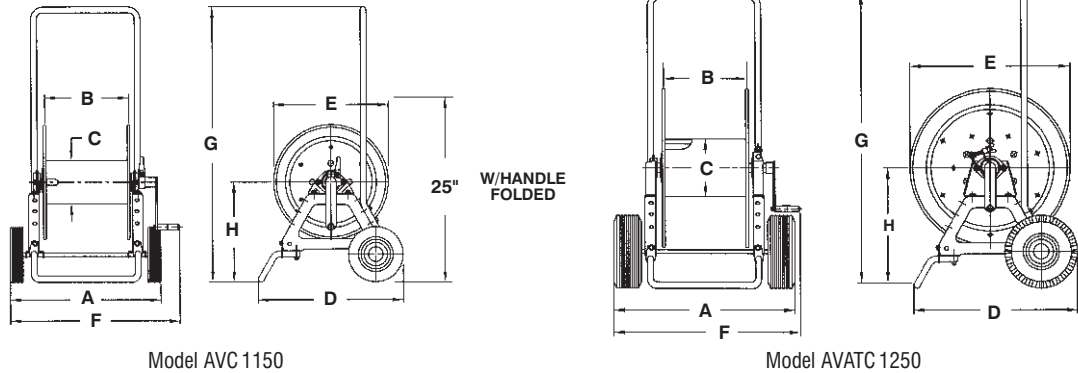

BE SURE TO CHECK DIMENSIONS AND WEIGHTS PRIOR TO ORDERING.

To receive a detailed parts breakdown drawing for Model AVC 1150, request ISO 48, for Model AVATC 1250, request ISO 87.

O.D. (in)	Cable Capacity of Reel							Model Number	Reel Dimensions								Approx. Weight	
	.245	.375	.41	.45	.49	.59	.67		Inches / mm.								lb.	kg.
O.D. (mm)	feet / m.							A	B	C	D	E	F	G	H	NET	SHIP	
6	10	10	11	12	15	17												
	950	800	700	575	425	250	AVC 1150	21.5	12	6	22	16.5	24.25	39	13.81	44	49	
	290	244	213	175	130	76		546	305	152	559	419	616	991	351	20	22	
	1800	1500	1200	1000	800	500	AVATC 1250	24.88	11.5	8	23	23	26.5	40	17.25	82	117	
	549	457	366	305	244	152		632	292	203	584	584	673	1016	438	37	53	

Specifications subject to change.

Notes:

When ordering AVC 1150 and AVATC 1250, specify model number, O.D., length and weight of cable, etc.

*UPS Shippable – some assembly required.

Optional AT Wheels on AVC 1150 increase dimensions, consult factory.

Removable Spool Portable Cable Reel



Cable Capacity of Reels								Model Number	Reel Dimensions								Approx. Net Weight		
feet m.									Inches mm.								Lb.	Kg.	
O.D. (in)	.245	.375	.41	.45	.49	.58	.67	AVCQ 20-14-16	A	B	C	D	E	F	G	H	Without Cable		
O.D. (mm)	6	10	10	11	12	15	17												
	• 700	525	400	400	250	175			15	12	6	15.5	14	16.75	19	8.62	12		
	• 213	160	122	122	76	53		381	305	152	394	356	425	483	219	5			

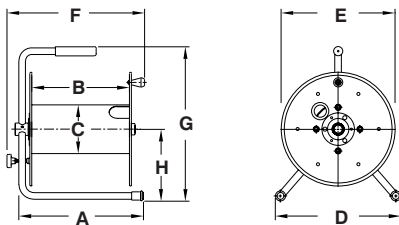

AVCQ 20-14-16

- Use Multiple Spools on One Frame
- Quick Release Spool Removal
- Self-Storing Removable Rewind Crank
- Ideal for Small Vehicles and Storage Areas.

Extra Spools can be stored on vertical or horizontal spindles of your own design, when needed transfer spool to frame for transport to work site. Sturdy steel construction with direct crank rewind provides fast, easy pick-up. Perfect for applications with long cable runs or large diameter cable. Adjustable friction brake is standard. Coated in a non-reflective black matte finish.

Simply Set-up And Tear Down

If you're looking for a better way to organize, store, and transport all the cables you use in studio production, live events or remote broadcasts, Hannay has the solution. Our AV, AVX and AVC series' audio/video reels are specifically designed to meet all your broadcast and pro-audio needs. These non-reflective black reels are durable and lightweight. Ergonomic carrying handles allow for one or two person transport. AV models are stackable and offer a removable side panel for complete customization of XLR and BNC connector patterns. With Hannay Reels, set-up and tear-down have never been easier.



Hannay Will Go To Any Length To Provide The Reel You Need

As the leading manufacturer of cable and hose reels, Hannay knows what you need in a reel. You need a reel that's long-lasting. Built to high standards. One that requires only minimal routine maintenance. A reel that helps you get the job done.

All our reels are made to stringent specifications, so you know you're buying reels you can depend on year after year, even under the most demanding conditions. Plus, we make reels for every application and every industry. We have over 2700 standard models and if one of these doesn't meet your needs, we'll work with you to design a reel that fits your specific application.

To Order Hannay Reels

Please refer to our Ordering Guide & Accessory Catalog. For more information on our 2700 standard models of cable and hose reels, please ask about specific product catalogs.

Custom Engineering Reels and spools.

Custom spools and reels for cable handling and storage can be built in an almost limitless range of sizes and with a wide variety of special features, such as divider discs, slotted discs, casters, etc. All rewind mechanisms described in this catalog can be specified for custom-built reels. To meet special requirements, motors used to power chain-and-sprocket rewind mechanisms can be mounted off the reel or within the reel frame.

Spools include the discs, tie-rods and spacers, and the drum. Since discs are inventoried in a range of standard diameters, and drum lengths can be adjusted, spools can be supplied to accommodate a wide range of cable sizes and lengths.

Orders and quotations:

See order form to supply proper information for orders or quotations, found in Ordering Guide & Accessory Catalog H-9412-OA.

Requests for quotations for custom reels and spools should include:

- Complete specifications on cable size, length and weight.
- O.D. and bending radius of cable.
- Number of conductors, voltage and amperage.
- Type of rewind mechanism, including available power for electric, hydraulic or air rewind motors.
- Complete description of how reel is to be installed and used.
- Specification of any accessories.



553 State Route 143
Westerlo, NY 12193-0159
Telephone 518-797-3791
TOLL FREE 1-877-GO REELS (467-3357)
FAX 1-800-REELING (733-5464) USA
FAX 518-797-3259 (International) www.hannay.com reels@hannay.com